

Custom Sized / Made To Order/measure Double Steel Security Personnel Pedestrian Door - Industrial Grade Exterior Outdoor Security Door

£994.99

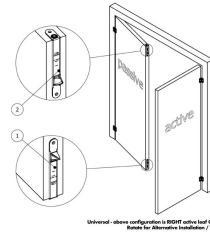

Universal - others configurations is RIGHT active leaf Open out
Handle for Alternative Installation / Direction

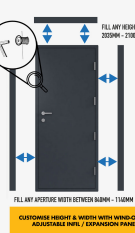
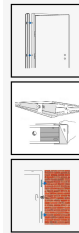

Select your door preference at checkout in the notes (as viewed from outside)

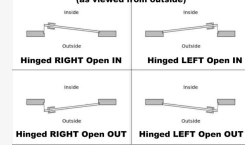

**OPEN IN or OUT
ACTIVE LEAF LEFT or RIGHT**

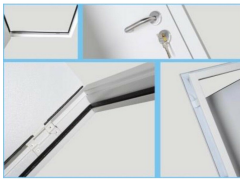

FIXING KITS FOR MASONRY/BRICK, TIMBER OR METAL STEEL FRAME

OPTIONAL WINDOW/LOUVRE VENT



Small Vision Panel Window
Slim Vision Panel Window
Louvre Vent



3 x Dog Leg Security Bolts on Hinge Side for Extra Security

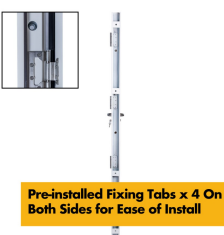

Pre-installed Fixing Tabs x 4 On Both Sides for Ease of Install

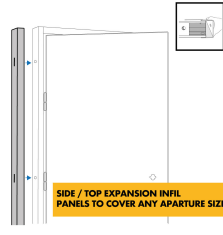

SIDE / TOP EXPANSION INFIL PANELS TO COVER ANY APARTURE SIZE



Pre-installed Gaskets on Both Door/Frame Saving Install Time

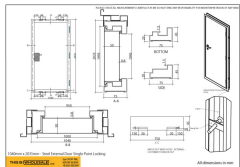

Pre-installed Fixing Tabs x 4 On Both Sides for Ease of Install

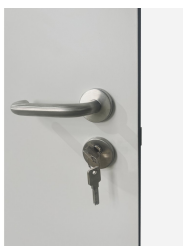
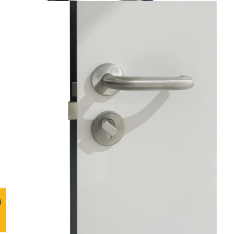



THIS IS A CUSTOM MADE PRODUCT ON A LEAD TIME OF 12-14 WEEKS. IF YOU CANNOT WAIT PLEASE DO NOT ORDER AS ONCE ORDERED, IT IS A NON CANCELLABLE AND NON REFUNDABLE CUSTOM MADE ITEM.

[Looking for stock sized double door 1800-1900mm w x 2035 - 2100mm High?](#)

Note: This is a universal door & the Active leaf (primary opening door) can be alternated by rotating the frame upside down 180°. The Active leaf is secured by handle and/or lock/key set. The passive leaf is secured by internal concealed flush bolts top & bottom which can be accessed after opening the primary leaf. the active leaf has door furniture only ie. handle, keyset, pushpad/bar etc.



4 x heavy duty hinges that offer extra security

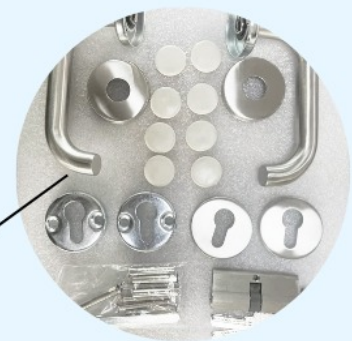

Full set of stainless steel handle & lock



3 sets of keys, single point locking mechanism



Full weather seal to all 4 sides of the frame

INSTRUCTIONS

Steel Personnel Pedestrian Door to fit 840mm x 2035mm opening

4pm CUT OFF TIME.
NEXT DAY DELIVERY.
10% TRADE DISCOUNT

1



Fit door in the hole hinged in the correct orientation (NOTE door is universal, i.e. can be fitted hinged on the left or right, just rotate 180° to so hinged on the opposite side).

2

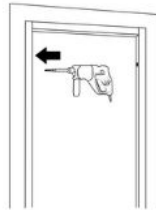

Once door is square & firmly in position, using the pre-drilled tabs, mark fixing positions on the building lining/frame & drill using suitable drill bit.

3

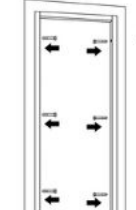

Optional: if ordered the extra add on vanity trim (not cover any caps/rods), this can be fitted on the opposite side & secured with suitable adhesive /mastic.

Use anchor bolts or suitable frame fixings to secure in place (washers are advised). NOTE - due to various types of frame being installed into i.e. brick, metal, timber, we are unable to supply the door with fixings.

4

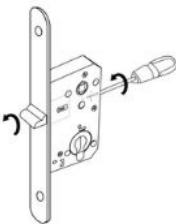

The lock mechanism latch can now be rotated to suit your configuration i.e. hinged left side or hinged right side using a screwdriver as shown.

5

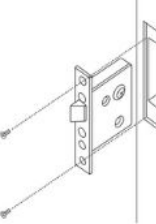

Insert the lock mechanism cassette into the door & secure with the 2 x M5 screws as shown.

6

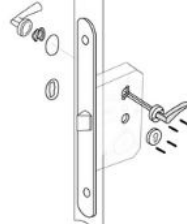

The lock barrel is fitted with with thumb turn from the inside / key insert to the outside. Handle & cover plate secured with screws as shown.

**UNIVERSALLY
HINGED LEFT OR
RIGHT**

Simply rotate the door 180° to hinge on the opposite side. Hinged side you can select at the point of installation depending on the orientation of the install.

BOTH IN & OUT POWDER COATING IN 5 DIFFERENT COLOURS

RAL 7016 Grey



RAL 9003 White



RAL 9005 Black



RAL 6007 Green



RAL 5005 Blue



UNIVERSALLY HINGED LEFT OR RIGHT. SIMPLY ROTATE THE DOOR 180° TO HINGE ON THE OPPOSITE SIDE. SIMPLY SELECT OPTIMUM HEIGHT AND WIDTH TO FIT YOUR SPACE. CAN BE FIT AT THE POINT OF INSTALLATION DEPENDING ON THE ORIENTATION OF THE INSTALL.

OPTIONAL WINDOW/ LOUVRE VENT

Steel security door for outdoor/ exterior use - industrial-grade personnel door is the ideal Security Door for Garage, Warehouse, Shed, Industrial Unit, Shipping Container, Farm Barn - can be primed & painted any colour yourself) complete with outer frame, & optional stainless steel door handle & lock with internal thumb turn & 3 sets of keys, single point locking mechanism). **OPTIONAL POWDER COATED COLOURS (AT EXTRA COST)**

- RAL 9003 WHITE (painted both sides in/out)
- RAL 7016 ANTHRACITE GREY (painted both sides in/out)



PLEASE NOTE - THIS IS ONE STANDARD SIZED 2035mm h x 1800mm wide - ITEM IS RECOMMENDED TO BE MEASURED, ORDERED AND INSTALLED BY A SUITABLE EXPERIENCED PROFESSIONAL AS WE DO NOT TAKE ANY LIABILITY FOR INCORRECT MEASUREMENTS. FULL TECHNICAL DRAWING WITH ALL DIMENSIONS IS BELOW & INSTALLATION INSTRUCTIONS.

FOR CUSTOM SIZES, PLEASE SEE OUR SIDE EXPANSION / EXTENSION PANELS THAT COME WITH WIND OUT LUGS ALLOWING EXTENSION OF BOTH SIDES AND HEADER SECTION FROM 10MM - 100MM. THIS MAKING THIS DOOR SUITABLE FOR ALL SIZED APERTURES FROM 1800 - 1900mm WIDTH AND 2035MM TO 2100MM H. FUTHER CUSTOM SIZES MADE ON REQUEST. CONTACT US FOR A QUOTE

Stock Door Size	+ 35mm Side Panel	+ 55mm Side Panel	+ 35mm Header Panel	+ 55mm Header Panel
1800mm x 2035mm	1810mm - 1850mm	1850mm - 1900mm	2035mm - 2070mm	2070mm - 2090mm

Optional Add on 500mm x 300mm Louvre Vent or 400mm x 400mm / 220mm x 1500mm Vision Panels - SELF INSTALLATION / CUTTING REQUIRED (these are supplied with the door only for the customer to install) see instructions below for details. This add on is not pre-installed by ourselves and is only supplied with the door for the customer / installer to fit. Requires a competent and experienced installer, we accept no liability for mis-installation / mis-cutting or damage to product during

installation. Frame powder coated both sides and will be sent the same colour as the door selected. Note: 150mm clearance must be left around all 4 sides of the door.

sales@thisiswholesale.co.uk | https://www.thisiswholesale.co.uk/

Weight: 135kg

[DOWNLOAD PDF TECHNICAL DRAWING / DIMENSIONS](#)

[DOWNLOAD STEEL DOOR INSTALLATION INSTRUCTIONS / MANUAL](#)

[DOWNLOAD INSTRUCTIONS MANUAL FOR SIDE/HEADER EXPANSION INFIL PANELS](#)

[DOWNLOAD VISION GLASS PANEL / LOUVRE VENT INSTRUCTIONS](#)

[DOWNLOAD FIRE EXIT PUSH PAD/BAR + OUTSIDE ACCESS DEVICE INSTRUCTIONS](#)

[DOWNLOAD FIRE EXIT PUSH PAD/BAR + EXTERNAL BLANK INSTRUCTIONS](#)

[DOWNLOAD DOOR EXTERNAL BLANK / BLANKING PLATE INSTRUCTIONS](#)

[DOWNLOAD COMBINATION CODE HANDLE LOCK INSTALLATION INSTRUCTIONS](#)

[DOWNLOAD HIGH SECURITY MULTI-POINT LOCKING INC. PAS24 & FIRE RATED STEEL DOOR INSTALLATION INSTRUCTIONS](#)

[DOWNLOAD WC VACANT/ENGAGED CONVERSION KIT INSTALLATION INSTRUCTIONS](#)

[DOWNLOAD MAINTENANCE MANUAL](#)

1800mm x 2035mm outer dimensions ie. to fit 1800mm x 2035mm cut out (clear opening 1710mm) - door frame thickness 75mm / door leaf thickness 45mm. - comes pre-hung in frame and fixing points located around the frame for easy install with the correct screws/fixings (not supplied) into brick, timber, steel or other building material. We recommend adding 5-10mm to the external size about for fitting which can be filled with foam / silicone. We would recommend adding a rain drip to any inward opening doors being installed externally helping to prevent water ingress. Frame features knock out weep holes at external footer.

WE STOCK ALL: CONFIGURATIONS OF DOOR OPENING INWARDS OR OUTWARDS, AS VIEWED FROM OUTSIDE- Doors are universal and can be fitted with hinges either on the left or the right hand as viewed from outside by rotating the pre-latch mechanism,- SEE IMAGE FOR FURTHER DETAILS ON CONFIGURATIONS WHEN SELECTING YOUR VARIATION OF DOOR AS INCORRECT ORDERS/RETURNS MUST BE RETURNED AT BUYERS COST. IF IN DOUBT PLEASE ASK.

Door Frame Material	<i>1.5mm Galvanised Steel</i>
Door Frame Thickness	<i>90mm</i>
Door Leaf Material	<i>Double skinned 0.7mm galvanised steel</i>
Door Leaf Thickness	<i>45mm</i>
Door Leaf Core	<i>50mm Mineral Wool Insulation</i>
Actual Door Size	<i>1943mm x 750mm/850mm/950mm</i>
U Value	<i>1.6 w/m²k (50mm Mineral Wool Insulation)</i>
Acoustic Value	<i>32dBa</i>

Hinges

4 Stainless steel hinges

text_phone 02920 099 098

sales@thisiswholesale.co.uk | <https://www.thisiswholesale.co.uk/>Lock *Eurocylinder*
Cylinder 70mm (35 -
 35)

- *NOTE: due to manufacturing tolerances with regards to batch variation, we recommend ordering all coloured/powder coated doors for a project at the same time, from the same batch as we cannot be held responsible for any variation that occurs between batches.*
- *Must be installed by a competent persons, we are not able to train, teach any DIY enthusiast how to fit a door correctly. Whilst its not a difficult job, each individuals competency and skill set varies and thus professional knowledge is advised to fit this product correctly, safely and securely for normal operation.*
- *Note - door includes mechanical / moving parts such as lock mechanism, hinges, latches and as such requires regular maintenance and upkeep ion the form of regular lubrication/oil applying.*